

C:\Documents and Settings\All Users\My Documents\Projects\All Users\My Documents\Drawings\PLATES\1147\plates\PIR\PLATE 3.dwg 17/08/2006 2:21:20 PM EST  
 PRG:2077  
 MINISTRY OF TRANSPORTATION, ONTARIO

**LEGEND**

- New Retaining Wall
- New Retaining Wall & Noise Barrier
- New Noise Barrier
- Existing Noise Barrier
- - - Existing ROW
- - - Temporary Property Requirement
- Permanent Property Requirement
- Pavement Widening or New Pavement
- - - 300 New Storm Sewer
- CB New Catch Basin
- New Concrete Barrier

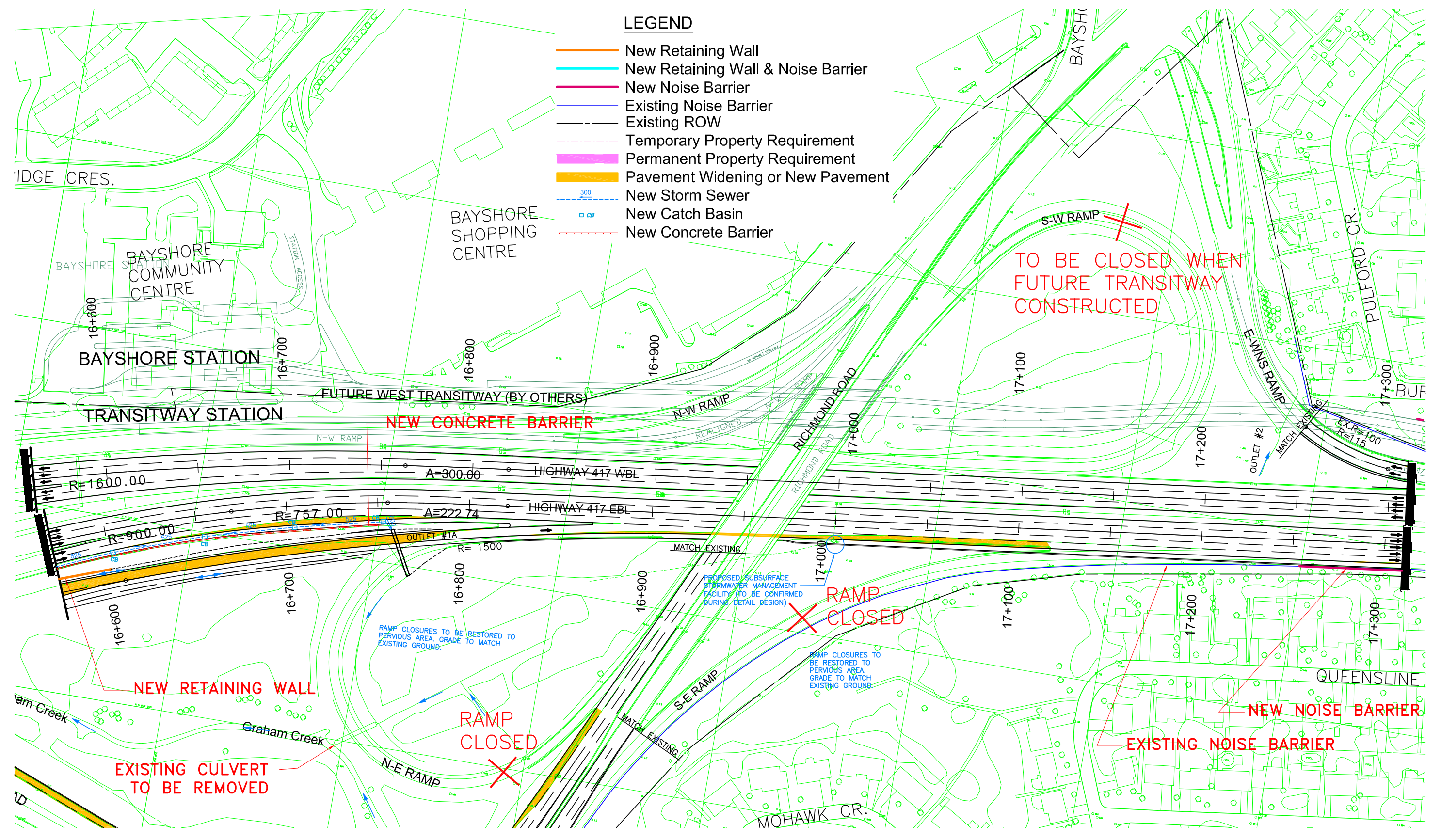

**Ontario**  
**UH**  
 engineers  
 architects  
 planners

**SCALE**  
 20M 0 40M  
 Horizontal

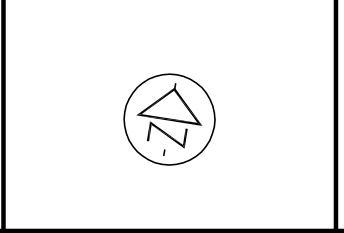

HIGHWAY 417, FROM HIGHWAY 416 TO  
 ANDERSON ROAD  
 PRELIMINARY DESIGN STUDY AND  
 ENVIRONMENTAL ASSESSMENT  
 G.W.P. 663-93-00

**RECOMMENDED PLAN**  
 STA. 16+570 TO STA. 17+310 (EB)  
 STA. 16+560 TO STA. 17+310 (WB)

**PLATE**  
3